

CALIBRATION OPTIONS

- K type (to 1100°C)
- J type (0°C to 750°C)
- T type (-200°C to 400°C) ②
- N type (to 1150°C)
- refer to quote for selection

SENSOR HEAD - SMALL (IP67)

- ALUMINIUM (STANDARD)
- BAKELITE
- OTHERS AVAILABLE UPON REQUEST

DIAMETER STANDARDS

- 3.0mm
- 4.5mm
- 6.0mm
- OTHERS AVAILABLE

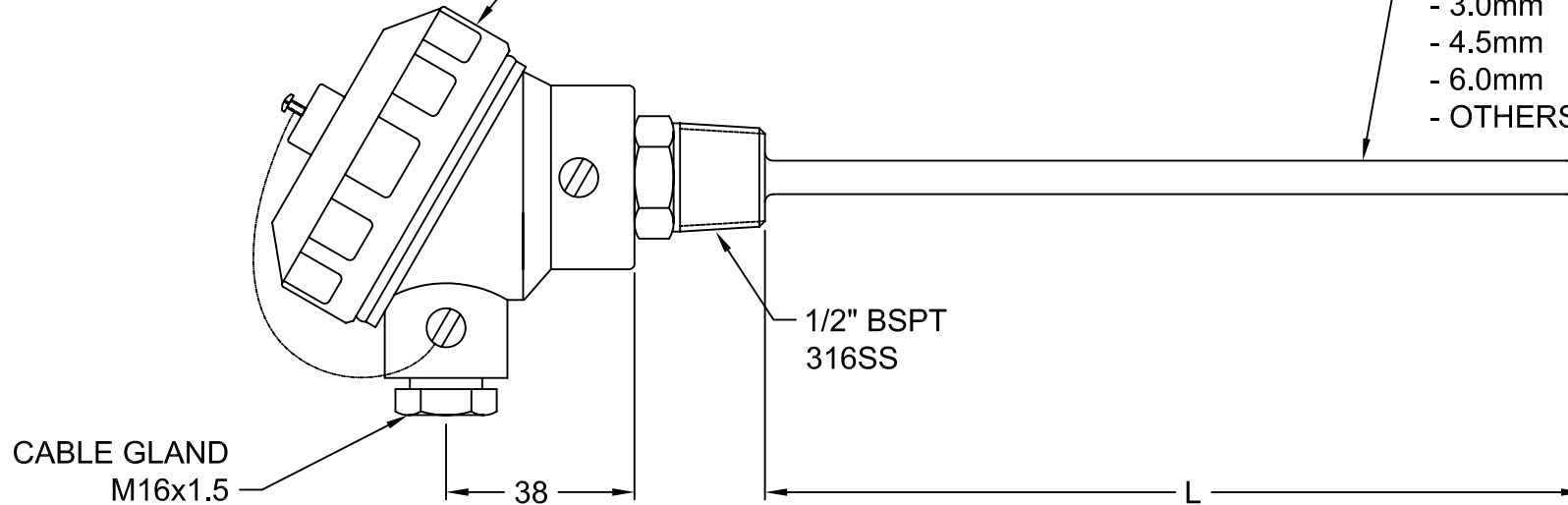

STANDARD THERMOCOUPLE CONSTRUCTION

- For standard operating temperature range, refer to Calibration Options table above
- Cold junction rated to 100°C
- Connector block is bakelite (ceramic optional)
- Process fitting is 1/2" BSPT
- Simplex construction
- Thermocouples are ungrounded mineral insulated cable in :
 - (K) - 310 stainless steel sheath
 - (J, T)- 316 stainless steel sheath ②
 - (N) - Inconel 600 or Pyrosil sheath

ADDITIONAL REQUIREMENTS

If variations from the standard construction, or additional features are required, please specify.

Options include:

- Different temperature ranges
- Grounded or exposed junctions
- Sheath material
- Higher temperature required at cold junction

2	DR	18/05/07	400°C WAS 200°C, TOLERANCES ADDED TO BORDER DETAIL J STANDARD SHEATH 316 SS WAS 310 SS
1	GC/DR	AUG 05	RE-DRAWN & RE-ISSUED
0	CL/RG	JUL 05	2nd ISSUE
APP	R.G	JAN 05	STANDARD TOLERANCES: 0 - 1000 ± 5 1000 - 2500 + 5 / - 15 2500 + ± 1.5 % ALL DIMENSIONS IN mm UNLESS OTHERWISE SPECIFIED
CKD	G.C.	NOV 04	
DWN	C.L.	MAR 04	
	NAME	DATE	



ECEFast
Electro Chemical Engineering Pty Ltd
AUCKLAND 01 100 100 770

1800 811 818
www.ecefast.com.au

0 800 ECE FAST
www.ecefast.co.nz

MELBOURNE
SYDNEY
BRISBANE
GLADSTONE (QLD)
AUCKLAND (NZ)

TEMP SENSOR
MODEL TS-11
1/2" BSPT PROCESS FITTING
SMALL HEAD

TS-11-CAT

ECE Dwg No.

Revision:

2

Units: mm

Scale: NTS