



ECEFastNZLtd®

## LS Series Multi Level Float Switches & Transmitters

Single unit or multiple reed switches are housed tightly in a 316 stainless steel stem. A permanent magnet which will activate the reed switch is inter-circled within the 316 stainless steel float. The float or floats are mounted on the stem and located by the use of 316 stainless steel collars. The rise and fall of liquid moves the float up and down. When the float's internal magnet approaches the reed switch, it will actuate the reed switch, to create a change of state in the circuit - i.e. either opening or closing the switch.

### LS Series - Common Specification

- All wetted parts 316 stainless steel
- Flange or nipple process connections, welded on the wet side
- Aluminium terminal head
- Maximum operating temperature 95°C

### LS Series - Common Options

- BS-milk, tri-clamp and other process connections
- Independent switching circuits
- Custom termination

### Reed Switch Action

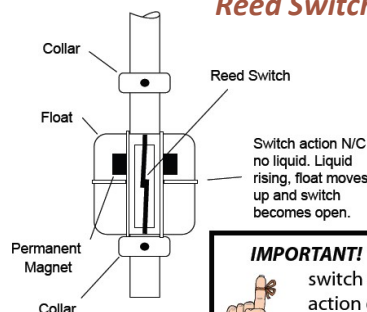

Switch action N/C no liquid. Liquid rising, float moves up and switch becomes open.

**IMPORTANT!** When specifying switch action, please state action of switch when tank is empty and at atmospheric pressure

### IMPORTANT!

- LS Series multilevel float switches are not designed to switch inductive or capacitive loads. In these cases, an intermediate protective device of appropriate capacity should be installed.
- Users of LS Series multi-level float switches should consult their own electrician for advice on any regulations concerning connection of these devices to mains supply.

### Float Specifications

Float type	A mm	B mm	C mm	SG	Material	Max pressure	Max Temp
S1	28	28	8	>0.8	316 SS	10bar	95°C
S4	52	52	15.0	>0.55	316 SS	30bar	95°C

### 2" table "E" Flange version

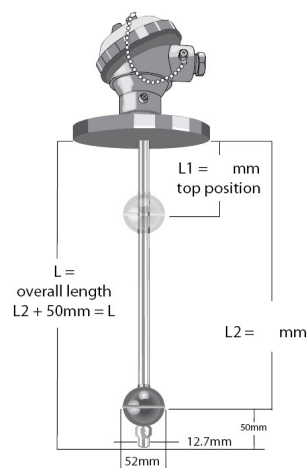

### 1" and 2" BSP version

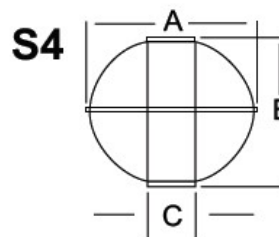
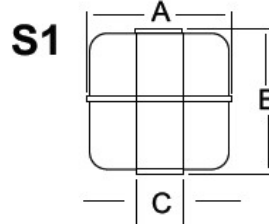
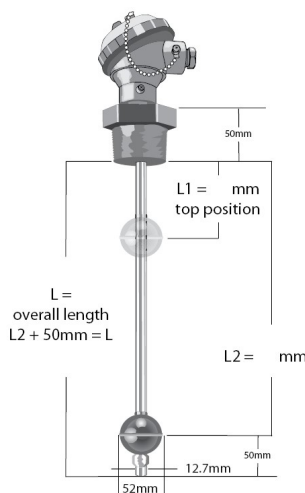

Custom designs to your specifications  
Free call 0800 323 327

### Ordering code

Overall Length : Max. 1500mm  
Process Connection : 1" and 2" BSP nipple / flange/ special (please specify)  
Termination Head : Aluminium / special (please specify)